

westerbergs

installation instructions and user manual

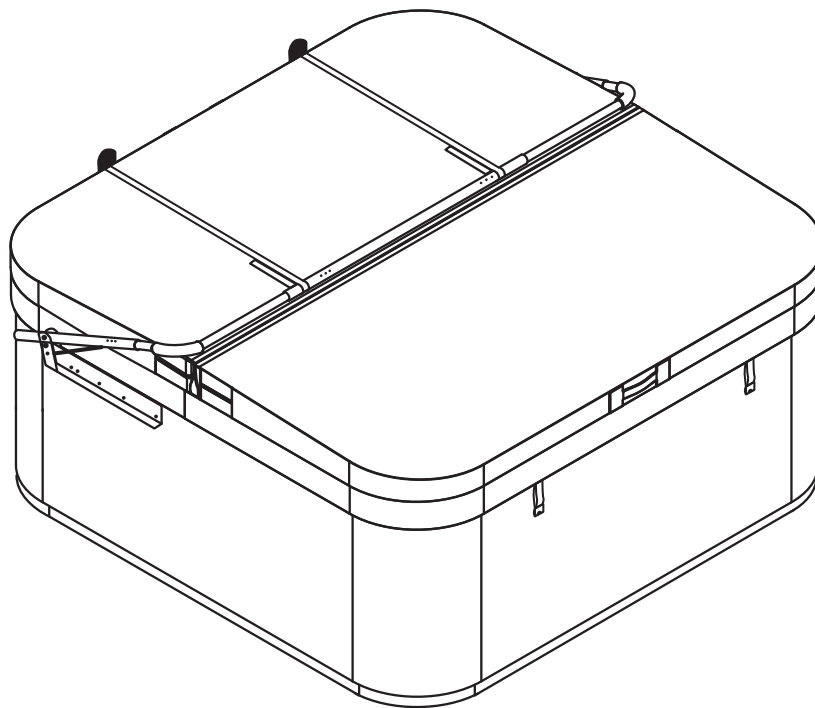

assembling kit



Left mounting bracket



Right mounting bracket



1x Coupler



2x Cover support arm



30x 1" Wood screw



42x Black PVC push cap



12x 1" Black tek screw



2x Carriage bolt



5x 1/2" Black PVC cap



3/8" Lock nut



2xSet of cover saver



1x Phillips driver



1x 1/8" Drill bit



5x 1/3" Washer



westerbergs

Make sure the spa cover is in closed position when you install the cover lifter.

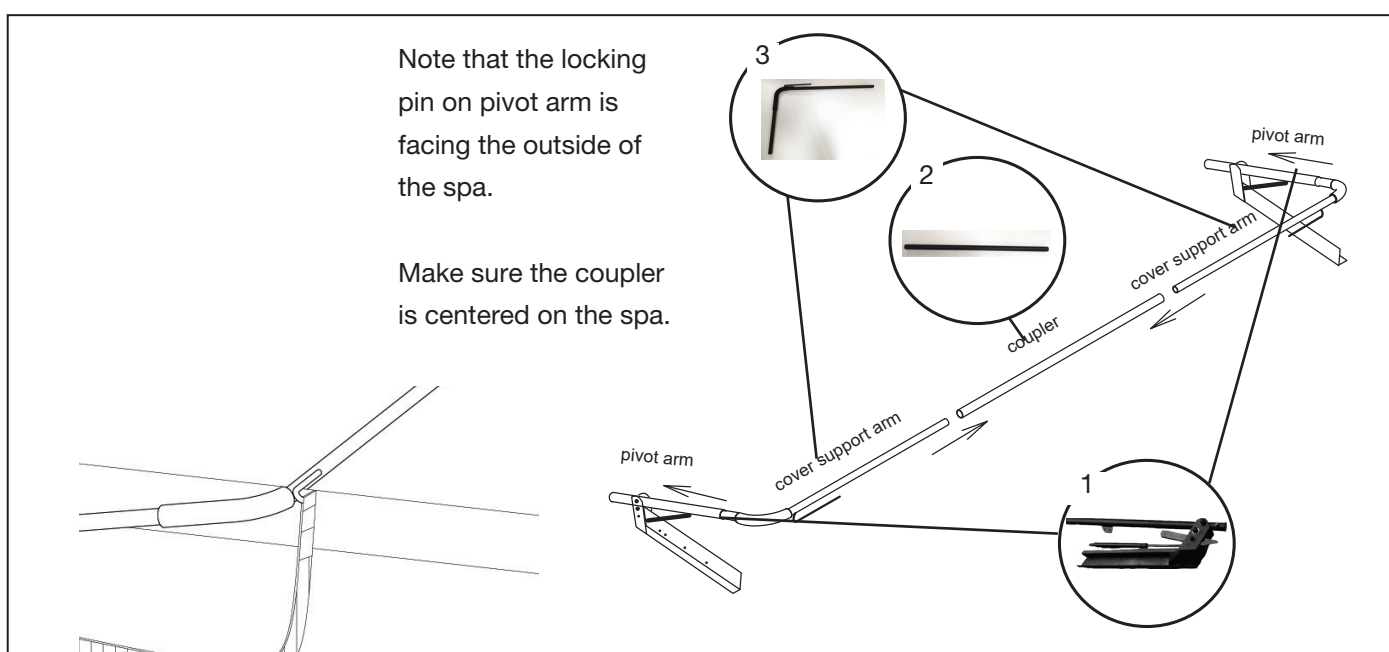
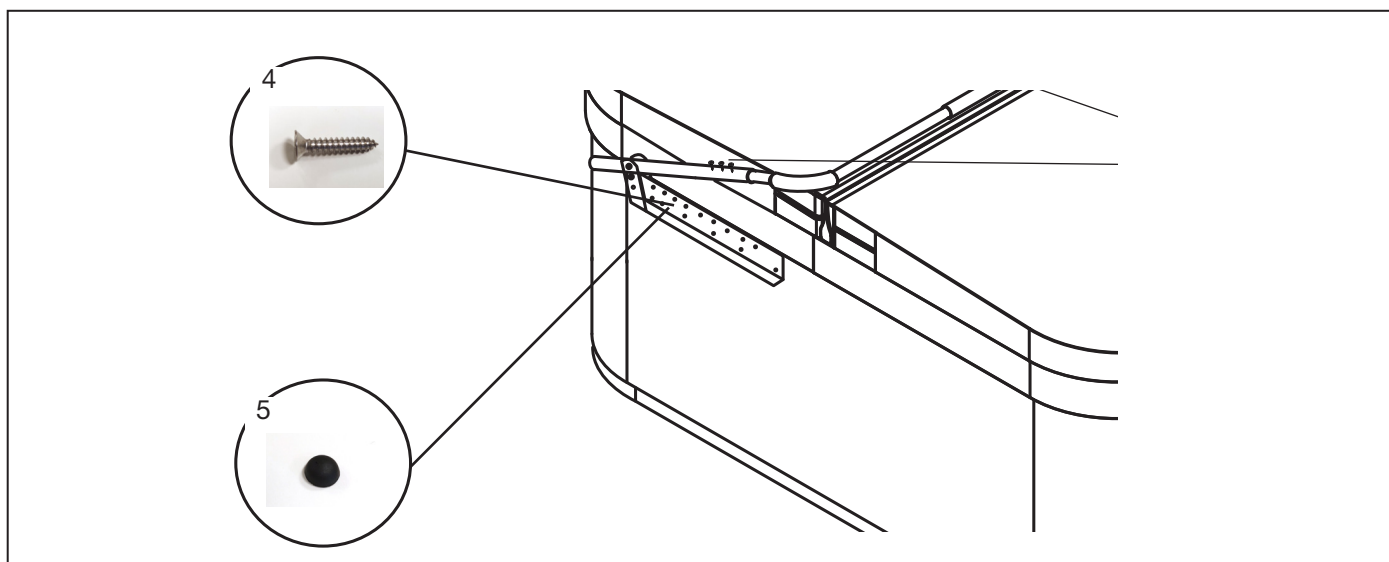
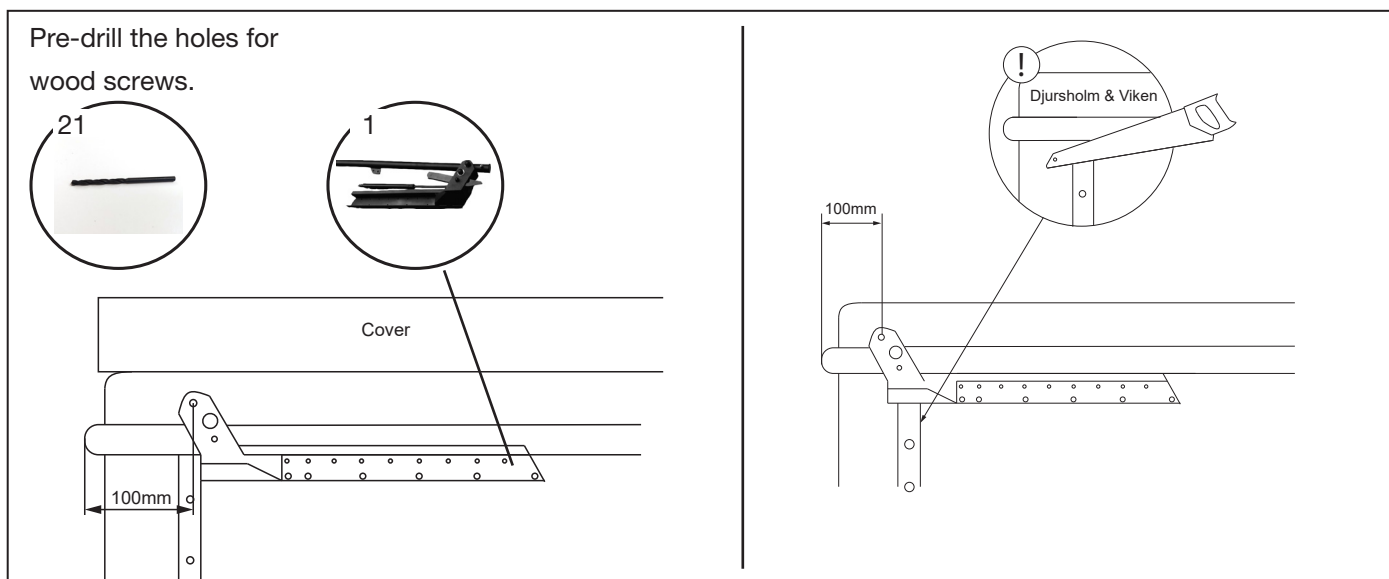

Note that the center bar should be 4cm from center of cover to prevent damages.

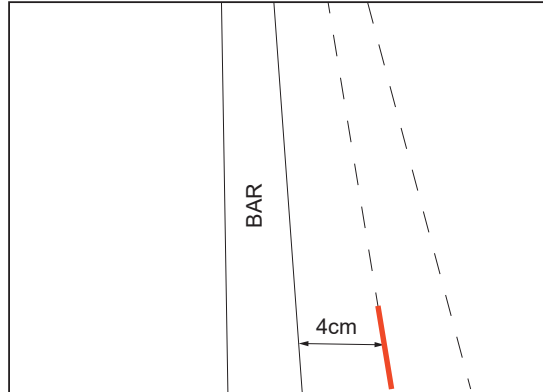

Make sure the center coupler is faced with the holes towards the back of the spa.

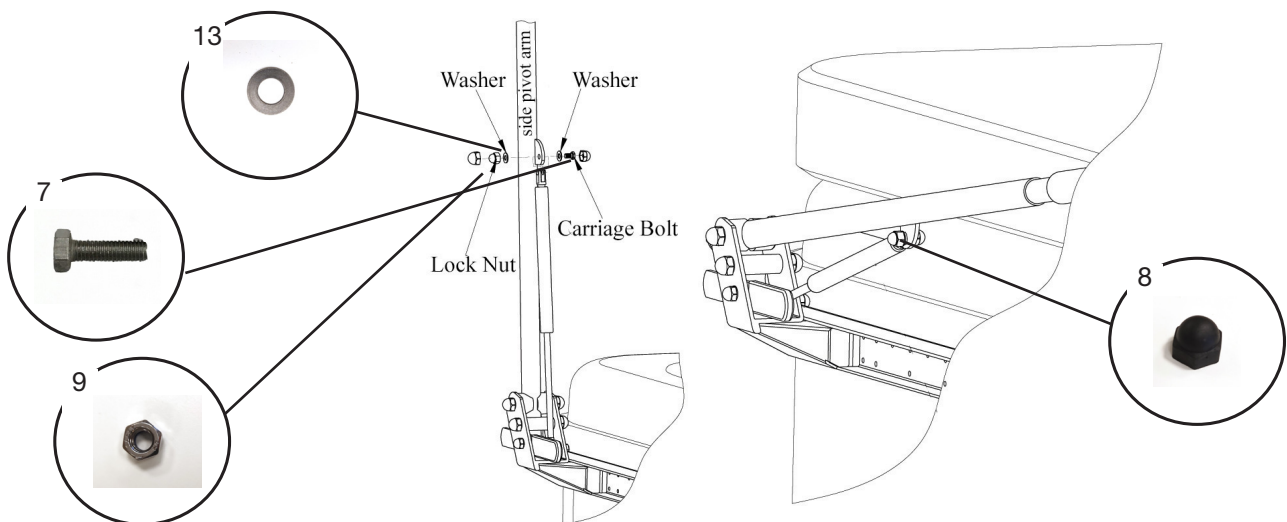
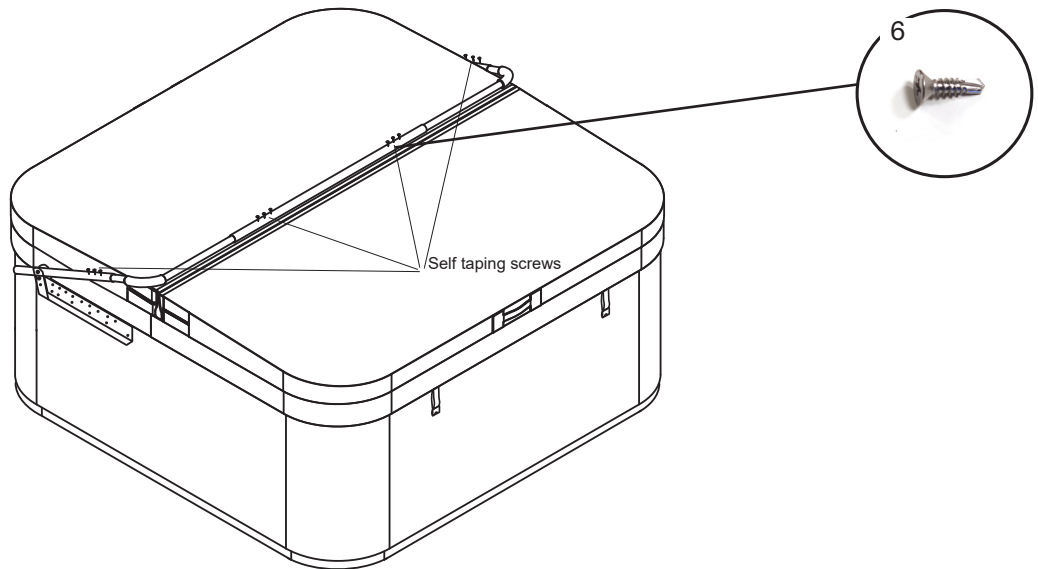



westerbergs

Cover protection instructions

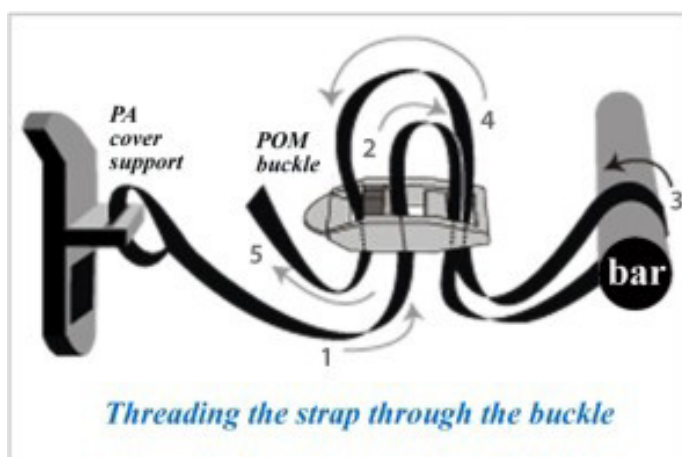
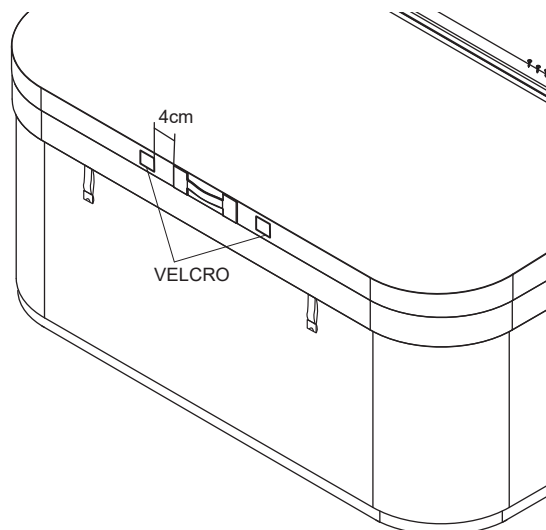

When the cover is in upright position, the cover should not be resting on the center bar.

Note that the weight of the cover should be resting on your cover protection if it's been properly installed

